

Share 2

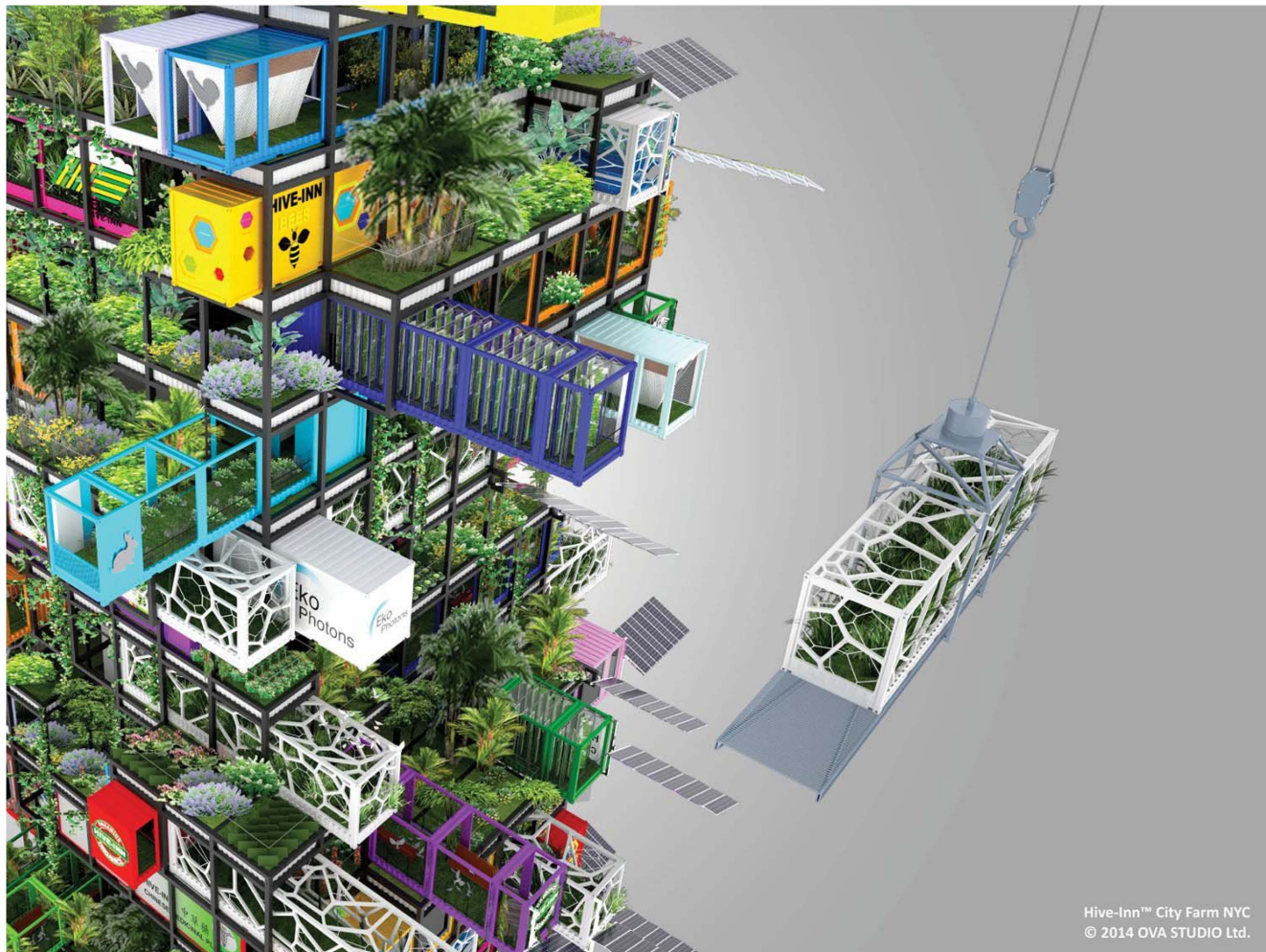

One glance and your head might start spinning. What exactly is this structure? You will be surprised to hear that the Hive-Inn City Farm NYC is actually a modular farming structure which transforms thrown-away (but easily reusable) shipping containers into perfect spaces to produce food and energy all while recycling waste and water. Too good to be true? We thought so too until we saw [Ova Studio's](#) master planning abilities.

SEE ALSO [New Hong Kong Hotel Design: A Real World Game of Jenga](#)

While we have seen a [modular structure from Ova Studio](#) before – specializing in luxury retail – this is one that we found particularly astounding and it was not only because of its physical form this time around. The plans actually have the potential to solve real-world sustainability issues that might arise down the line for major cities like New York. In recent years especially, an emphasis has been made on buying local produce and products in efforts to help local economies. This is both in relation to high costs of transport of goods and in keeping money circulating and “within” communities.

The problem here – especially for large cities – is that there isn't too much space to really implement this idea without having to outsource at least a bit. With [CSA's](#) (Community Supported Agriculture) popping up here and there – bringing fresh produce from surrounding areas (i.e. Upstate New York) and bordering states – we are surely making do, but couldn't we do better? This is a pressing issue and question we must ask ourselves due to the rapidly growing populations in urban cities. As a matter of fact, according to census forecasts, over 70% of the world population will be living in cities by 2025.

These are the hard-hitting questions and facts that architects and planners at Ova Studio are attempting to answer and face boldly.



Of the concept, Ova Studio says:

“The idea of this ecosystem is to bring farming downtown and grow fresh produce near their urban consumers. Containers can be owned or rented by major organic brands, local restaurants, or even serve as private local gardens/kitchen gardens. They can also serve educational purposes for the neighboring schools.”

While the idea is surely brave, we also think it is necessary. In addition, their plans are carefully thought through to a T, so this isn't just a (radical) shot in the dark. As you can see in the beautifully rendered images, maps, and graphs below, everything down to the heat and plumbing has been planned methodically.

SEE ALSO [First Airborne Wind Turbine to Bring Renewable Energy and WiFi to Alaska](#)

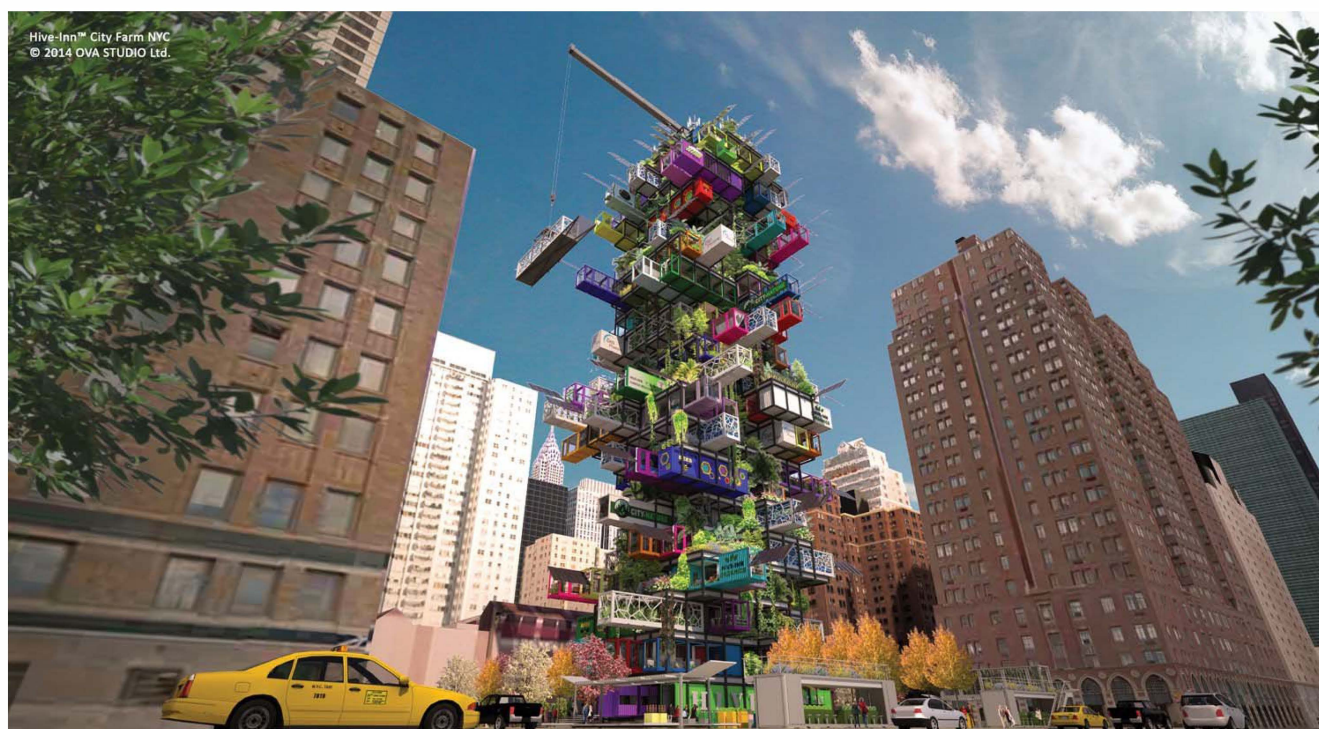



You might be wondering what (if any) the benefits of such a complicated-looking structure could be, and we would like to tell you that there are many! The fact that the Hive-Inn City Farm NYC is made up of shipping containers makes it incredibly sustainable and efficient to build. Forget about paying millions upon millions for building materials, these upcycled containers promote the reuse of "waste" while cutting down on costs. In addition, each container is highly movable – allowing overseers to swap "shops" in and out. No need for costly renovations!



Hive-Inn™ City Farm NYC
© 2014 OVA STUDIO Ltd.

Take a look at some of the carefully mapped out spaces and possibilities for the New York City structure, from gardens, to beehives, and aquatic life:

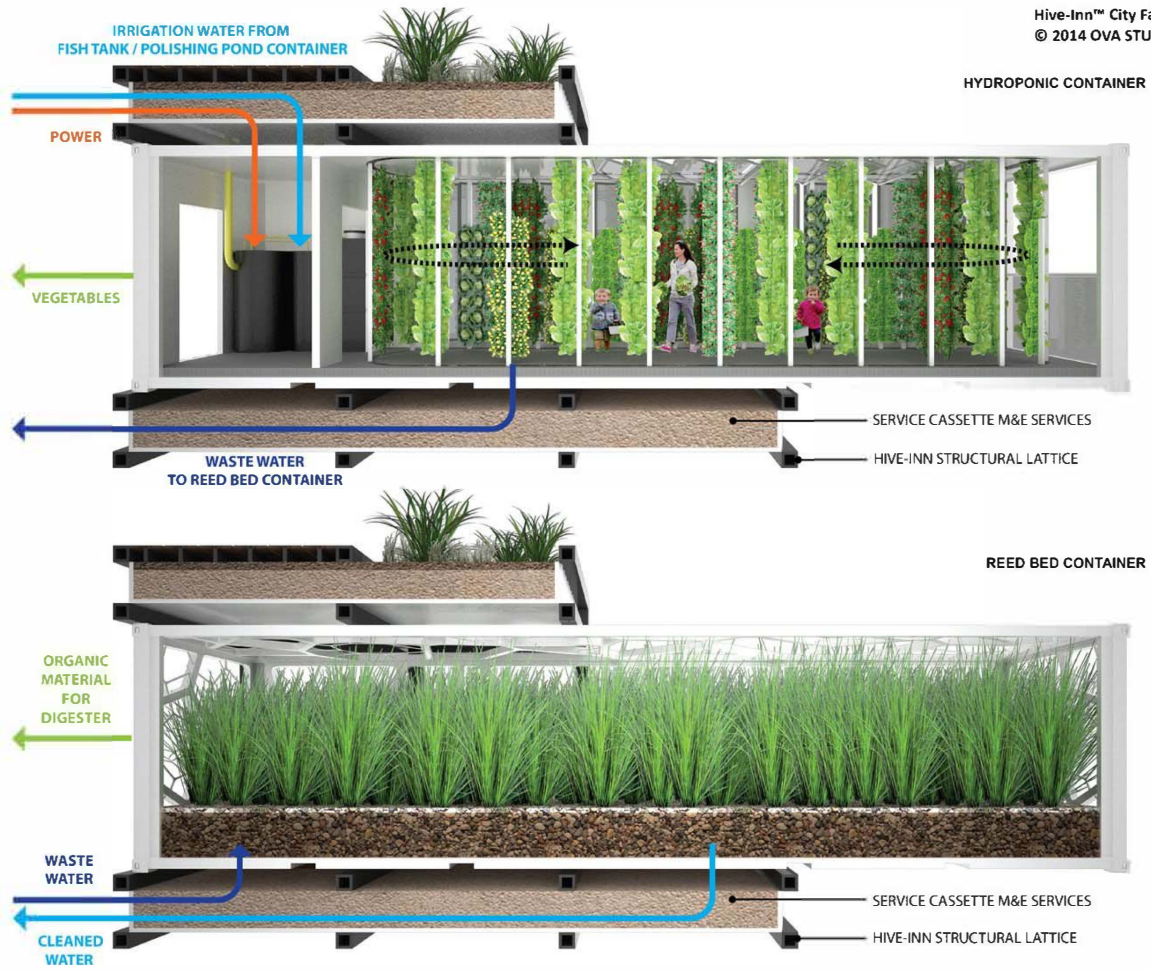

Hive-Inn™ City Farm NYC
© 2014 OVA STUDIO Ltd.



Hive-Inn™ City Farm NYC
© 2014 OVA STUDIO Ltd.



Hive-Inn™ City Farm NYC
© 2014 OVA STUDIO Ltd.



**HIVE-INN CITY FARM
MAIN COMPONENTS AND CONTAINER TYPES**

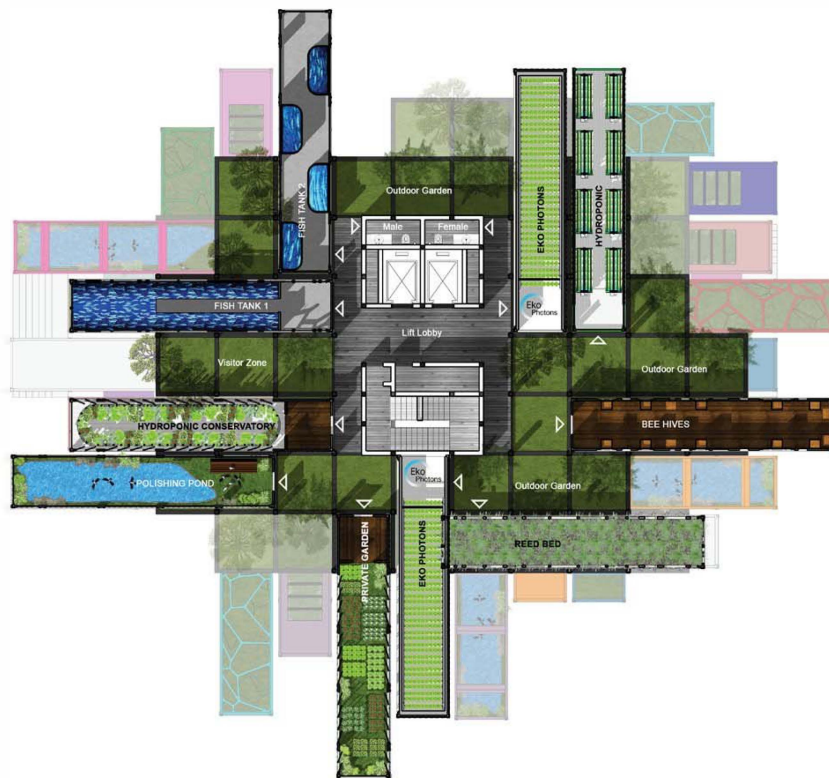
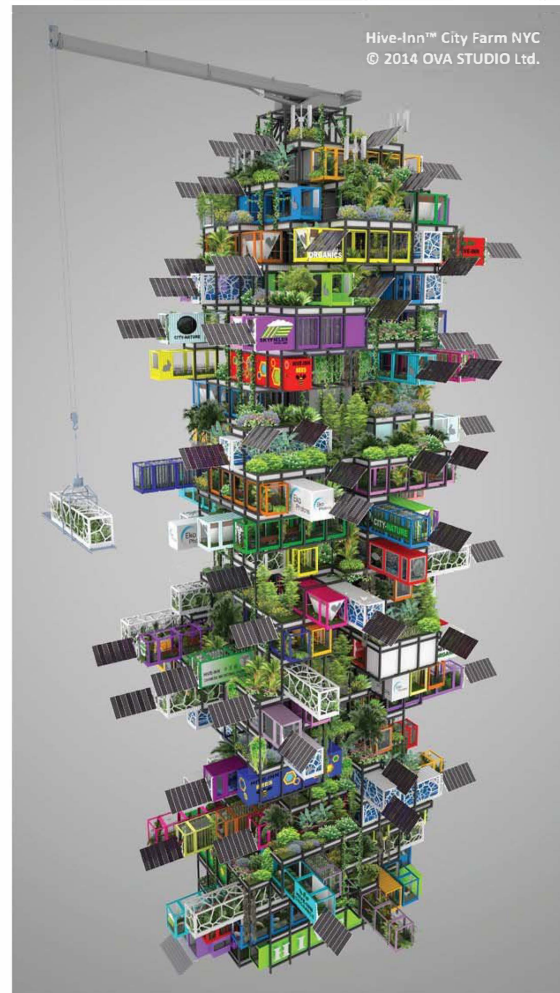

TYPICAL FLOOR PLAN



All images courtesy of Ova Studio

Finally, it is important to mention the exact location the architects at Ova Studio would consider placing the “Hive-Inn”. The first site would be at 39th/40th St & 1st Ave, which is right by the United Nations headquarters. Their desire to place it there directly correlates to two reasons – the first being that it is currently a vacant parking lot – wasting valuable New York City real estate – and the second reason being more theoretical. Being in one of the most iconic cities in the world and so close to an organization with worldwide reach, the possibilities for the Hive-Inn to spread would be endless.

In addition to New York City, Ova Studio has said that they see the concept spreading to other large cities in need of (truly) local, organic produce such as Seoul, Tokyo, Shanghai, Beijing, Berlin, Rotterdam, Toronto, Seattle... and more! Could this awesome idea be coming to you?

For more Cities & Structures, [check out our articles here.](#)

What do you think of this modular farming system? Could it work?

Subscribe to our mailing list for weekly updates!

Subscribe

FROM OUR FRIENDS



[Guess the Tablet: The Cheapest Tablet Nobody Paid Attention...](#)

[TechnoBuffalo](#)

[Smash Cup](#)

[BLTD](#)



[6 Office Pranks That Won't Get You Fired](#)

[Fast Company](#)



[Steal This Look: A Humble Tuscan Kitchen, French Edition](#)

[Remodelista](#)

powered by PubExchange

Share ◀ 2

- TAGS
- [agricultural design](#)
- [agriculture](#)
- [agriculture news](#)
- [City Farm](#)
- [community supported agriculture](#)
- [Hive-Inn](#)
- [Hive-Inn City Farm NYC](#)
- [new york](#)
- [new york agriculture](#)
- [new york city](#)
- [new york city architecture](#)