



Shopping? Check out our latest product comparisons



Super slim wallets designed to...
SET YOUR POCKETS FREE



SpaceX releases video of powered booster landing



Modular, electric bike trailer provides strain-free haulage



Samsung Galaxy S5 vs. LG G3: A Closer Look



New technique could boost internet speeds tenfold

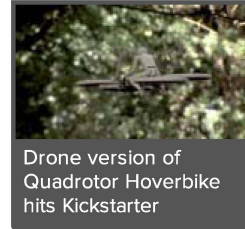

Drone version of Quadrotor Hoverbike hits Kickstarter

MORE TOP STORIES

ARCHITECTURE

Inner city vertical farm concept designed using shipping containers

By [Stu Roberts](#)
July 22, 2014

8 Comments
15 Pictures

hktdc.com
SMALLORDERZONE
Start Sampling from Verified Suppliers
Get \$30 Shipping Rebate Today!
Place Order Now!



The Hive-Inn City Farm is a concept by OVA Studio aimed at re-localizing food production

[Image Gallery](#) (15 images)

Vertical farming and building with shipping containers have been touted as solutions to dwindling space in cities and costly construction, respectively. A new concept wants to combine the two as a means of re-localizing food production. The Hive-Inn is a modular and adaptable city farm design proposed for New York.



→
[View all](#)
→

Recent popular articles in Architecture

Casa Futebol concept would turn World Cup Stadiums into low-cost housing

Urban Skyfarm concept would provide inner city farming space

Gizmag has featured many vertical farming projects, shipping container builds and concept designs for both over the years. In 2009, we asked [whether or not vertical farming could solve a global food crisis](#) and last year we featured [10 of our favorite shipping container-based structures](#).

Other related ideas include Eugene Tsui's [two-mile-high termite nest concept](#), designed as a solution to the world's burgeoning population, and the [composting islands proposed for New York](#) by Present Architecture.



The Hive-Inn City Farm concept, designed by OVA Studio, extols the virtues of reconnecting people with nature and bringing food production back into cities. It aims to give citizens back understanding and control of food production. The concept incorporates community kitchen gardens, neighborhood cooperatives and supermarkets selling locally grown produce direct from producers. It is proposed that the structure would be used to produce crops including green vegetables, tomatoes, corn, and honey.

"The revenues generated by Hive-Inn City Farm are essentially from food production, which we believe can be sold at lower prices than those of present organic produces, because we cut off transportation costs and costs associated with middlemen," explains OVA in a press release.

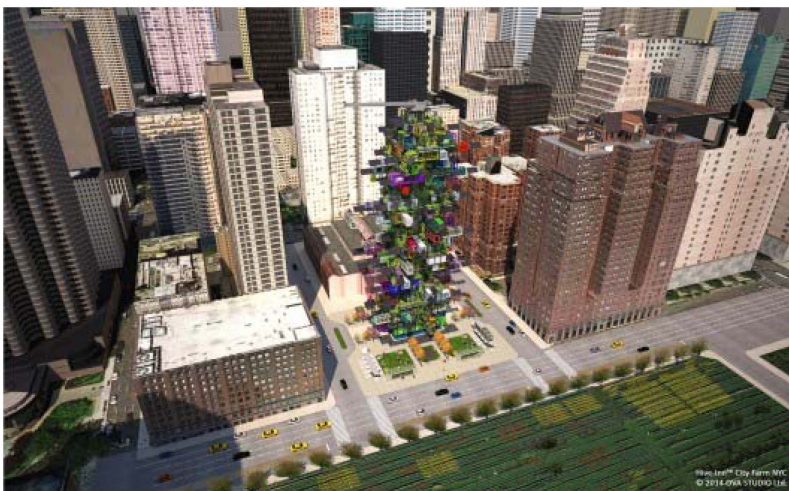

The basis of the Hive-Inn is a vertical, modular structure made up of a frame that holds shipping containers. The structure is to be viewed as an adaptable composition of containers that can be slotted in, removed or rearranged as required. The containers are used in their unmodified form, ensuring that they remain easily movable and that there is no unnecessary money spent on modifications. Containers could be removed and relocated elsewhere were a building tenant to move on.

The concept proposes that each container plays a role in producing food, harvesting energy and recycling waste and water. Rainwater is collected

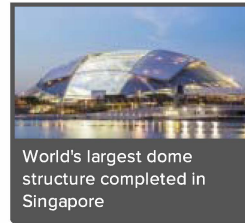

World's largest dome structure completed in Singapore



Viennese squeeze: CJ5 house offers slim solution to urban density



Bamboo treehouse eco-hotel concept is at one with the birds



Mayor of London unveils three proposals for the future of Heathrow



BioCasa 82 boasts bragging rights as Europe's first LEED Platinum home



Inner city vertical farm concept designed using shipping containers

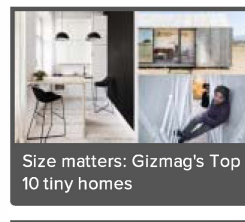

Size matters: Gizmag's Top 10 tiny homes



Living in style 12 meters from a busy railway line

hktdc.com
SMALLORDERZONE
Start Sampling from Verified Suppliers
Get \$30 Shipping Rebate Today!
Place Order Now!

Sections

[Features](#)

[Reviews](#)

[Aircraft](#)

[Architecture](#)

[Around The Home](#)

[Automotive](#)

[Bicycles](#)

[Children](#)

[Computers](#)

[Digital Cameras](#)

[Electronics](#)

[Environment](#)

[Games](#)

[Good Thinking](#)

[Health and Wellbeing](#)

[Holiday Destinations](#)

[Home Entertainment](#)

[Inventors and Remarkable People](#)

[Laptops](#)

[Marine](#)

[Medical](#)

[Military](#)

[Mobile Technology](#)

[Motorcycles](#)

[Music](#)

and fed to storage tanks for use in watering plants and grey water (used water collected from sinks, showers and baths) is collected for use in toilet plumbing. Toilet and animal waste is collected and fed through a "multrum" system to produce compost for feeding plants and methane for producing electricity. Waste paper and organic material can also be used in the methane production process.

[Outdoors](#)

[Pets](#)

[Robotics](#)

[Science](#)

[Space](#)

[Sports](#)

[Telecommunications](#)

[Urban Transport](#)

[Wearable Electronics](#)



Although only a concept at present, OVA hopes to bring the Hive-Inn into reality and is seeking investors and partners worldwide. An initial site is earmarked in New York not far from the UN Headquarters and OVA suggests that other suitable cities include Seoul, Tokyo, Shanghai, Beijing, Berlin, Rotterdam, Toronto and Seattle.

The company is hoping to raise an initial round of funding to the tune of US\$1.5 million, that it says would cover a feasibility study and a prototype.

Source: [OVA Studio](#)

Share

Log In

29	6	5	3	9
Tweet	g+1	Pin it	in Share	reddit



More from Gizmag